

LegendAir-HPT Inflatable Tent 72 m²

-  Durable
-  Roll-up doors
-  Weather proof hood
-  Partitioning curtain

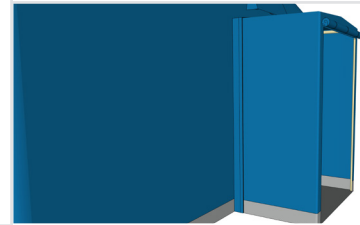
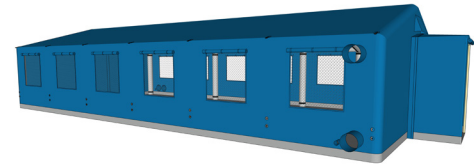
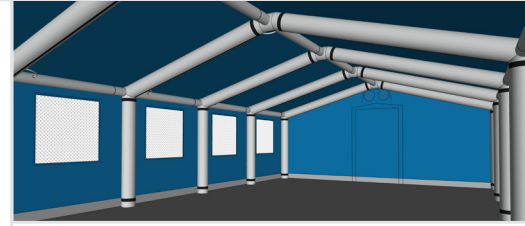
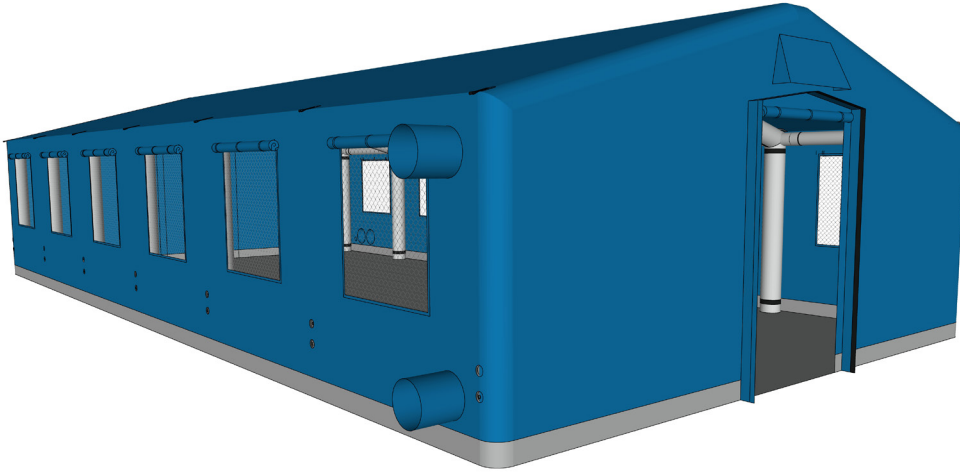

› Description

- » High performance multipurpose tent with integrated inflatable structure for fast deployment
- » Fitted with vertical side walls for optimal use of internal space
- » Temporary free-standing shelter solution for medical, operational and accommodation applications

› Specifications

System	Medium pressure self-erecting inflatable tent
Dimensions	House shape design with vertical walls
Floor area	6.00 x 12.0 m
Side wall height	2.10 m
Center height	3.15 m
Door	<ul style="list-style-type: none"> » Roll-up door with heavy-duty zipper and fold-down threshold - 120 x 210 cm - 1 in both gables » Prepared for mounting with a Connection Module* or Entry Module* <p><i>Special configurations with doors in the side walls available on request</i></p>
Windows	3-layer windows - PVC mesh / clear PVC flap / cover fabric flap - 80 x 80 cm - 6 per side wall, 12 in total
Ventilation	PVC mesh ventilation grates in gables with weather proof hood
Ducts	<ul style="list-style-type: none"> » Double ducts in each side wall, 350 mm Ø with closing flap » Cable entry duct in each side wall, 80 mm Ø with closing flap
Standard features	<ul style="list-style-type: none"> » Fixing points for Partitioning Curtain, Insulation liner* or Ceiling net* » Hanging loops for lights and medical equipment

› Graphic reference

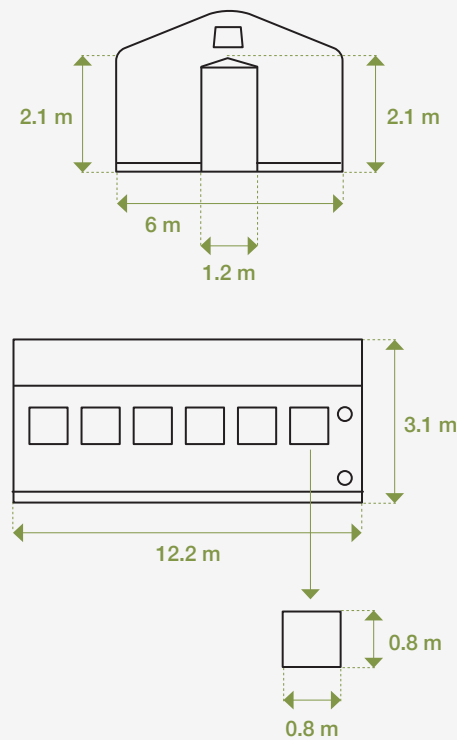

LegendAir-HPT Inflatable Tent 72 m²



› Standard accessories

- › Guy ropes, stakes and hammer in PVC fabric bag
- › 1 Partitioning curtain in bag
- › Foot pump
- › Repair kit for air frame, outer cover and groundsheet
- › Assembly and user manual

› Optional accessories

Inflator	Dual-motor electrical inflator 220V with hose kit 72 m ²
Partitioning curtain	550 g/m ² PVC fabric
Ceiling net	
Insulation liner	Quilted double layer soft-feel polyester with polyester wadding - breathable - FR CPAI-84 - disinfectable
Entrance module	135 x 100 x 210/225 cm
Connection module	135 x 100 x 210/225 cm
Lighting kit	LED light tubes 2,400 lumens, Schuko sockets + USB and main power distribution boards 4x16A 220V

› Materials, construction and performance

Materials	Cover & floor 700 g/m ² PVC coated polyester fabric, UV resistant, FR class B1
Air frame	500 g/m ² PVC coated polyester fabric with 100% airtight TPU liner
Air frame construction	<ul style="list-style-type: none"> › 7 arches with inflatable purlins › 7 air chambers each with 2 inflation/deflation valve and overpressure safety valve
Operating pressure	350 mbar (5 psi)
Operating temperature	-40 C / +50 C
Wind resistance	<90 km/h
Snow load	<12 kg/m ²
Set up time	20 minutes / 2 people

› Packing and shipping

Dimensions	150 x 115 x 75 cm	*including guy ropes, stakes, hammer, partitioning curtain, repair kit, user manual
Weight	285 kgs approx.	

Packing unit

Dimensions	150 x 115 x 90 cm	Inflatable tent with accessories packed in PVC transport bag on wooden pallet
Weight	310 kg approx	
Volume	1.553 m ³	

› Estimated loadability

Containers	Pallets	Units	Weight
20 FT	12	12	3,960 kgs approx
40 FT	32	32	10,560 kgs approx.

LegendAir-HPT | Electrical Inflator



› Technical specifications

System	Twin motor centrifugal inflator/deflator
Airflow	1200 l/m - 2000 l/m
Max pressure	140 mbar (2.0 psi) - 350 mbar (5,1 psi)
Operating temperature	-10 C / + 40 C
Power supply	220V / single phase / 50 Hz / Schuko plug
Nominal consumption	single motor 1000 W / twin motor 2000W
Nominal current	4.5 A / 9.0 A
Inflation hose kit	Hose 40 mm Ø / 20 mm Ø adaptor

Inflator

Dimensions	35 x 26 x 18 cm
Weight	4.2 kg

Hose kit

Dimensions	40 x 40 x 10 cm
Weight	3 kg

› Graphic reference

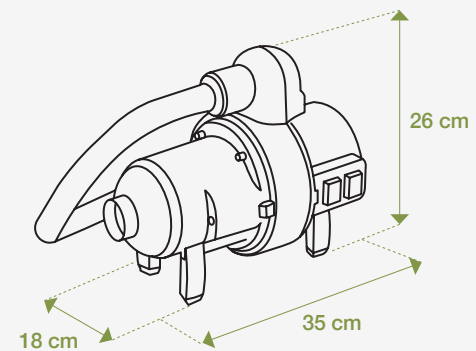

LegendAir-HPT | Electrical Inflator

› Packing and shipping

Inflator (48 units on pallet)

Dimensions	120 x 120 x 80 cm
Weight	227 kgs approx.
Volume	1.152 m ³

Hose kit (60 units on pallet)

Dimensions	120 x 115 x 80 cm
Weight	205 kgs approx.
Volume	1.104 m ³

› Estimated loadability - Inflator

Containers	Pallets	Units	Weight
20'	24	1,152	5,448 kgs approx.
40'	66	3,168	14,982 kgs approx.

› Estimated loadability - Hose kit

Containers	Pallets	Units	Weight
20'	24	1,440	4,920 kgs approx.
40'	66	3,960	13,530 kgs approx.

LegendAir-HPT | Entrance Module



Protection from cold and warm weather



Metal support frame

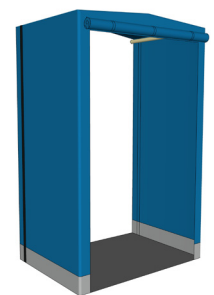
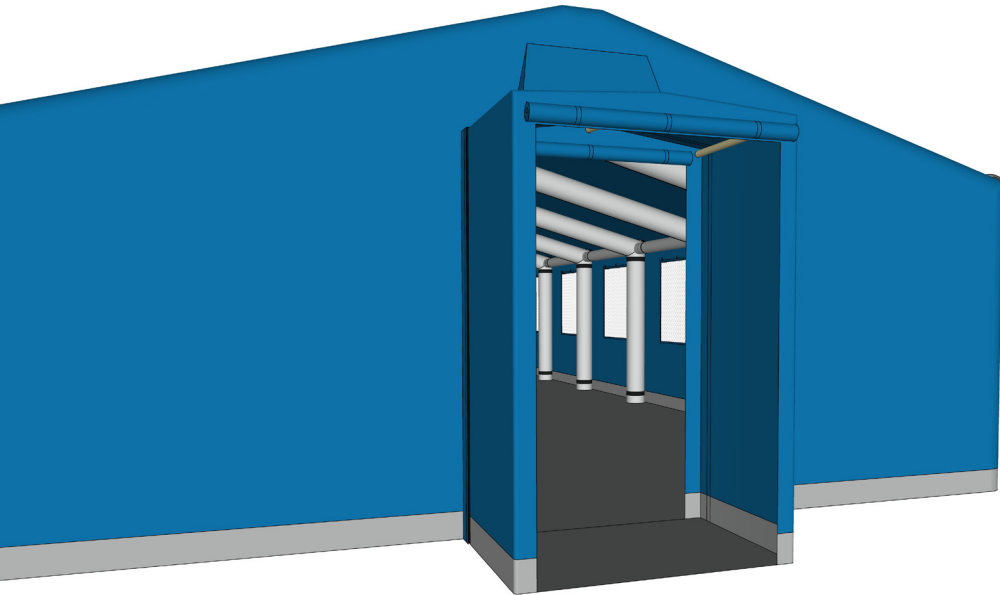

› Description

- › Vestibule area with metal support frame to be mounted against the entrance door
- › Creates a protected porch between the cool or warm end dry tent environment and the outside weather conditions

› Specifications

Dimensions	1.35 x 1.0 m (Floor area)
Side wall height	2.10 m
Center height	2.25 m
Door	Roll-up door with heavy-duty zipper and fold-down threshold - 120 x 210 cm
Standard features	Hanging loops for lights
Standard accessories	<ul style="list-style-type: none"> › Guy ropes › stakes and hammer in PVC fabric bag › Assembly and user manual
Cover and floor	700 g/m ² PVC coated polyester fabric, UV resistant, FR class B1
Operating temperature	-40°C / +50°C

› Graphic reference

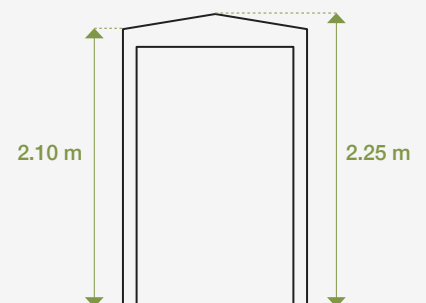
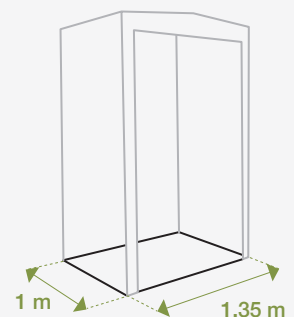

LegendAir-HPT | Entrance Module



Protection from cold and warm weather



Metal support frame

› Packing and shipping

Dimensions	115 x 80 x 15 cm
------------	------------------

Weight	22 kgs
--------	--------

* including guy ropes, stakes, hammer, user manual

Packing units (Six entrance modules with accessories individually packed in PVC transport/carry bag on wooden pallet)

Dimensions	150 x 80 x 105 cm
------------	-------------------

Weight	157 kgs approx
--------	----------------

Volume	0.966 m ³
--------	----------------------

› Estimated loadability

Containers	Pallets	Units	Weight
20 FT	28	168	4,396 kgs approx.
40 FT	60	360	9,420 kgs approx.

LegendAir-HPT | Insulation Liner 72 m²



Protection from cold and warm weather

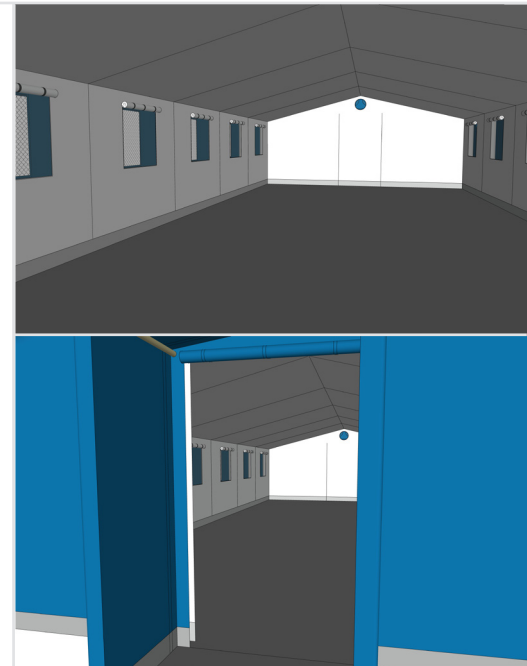
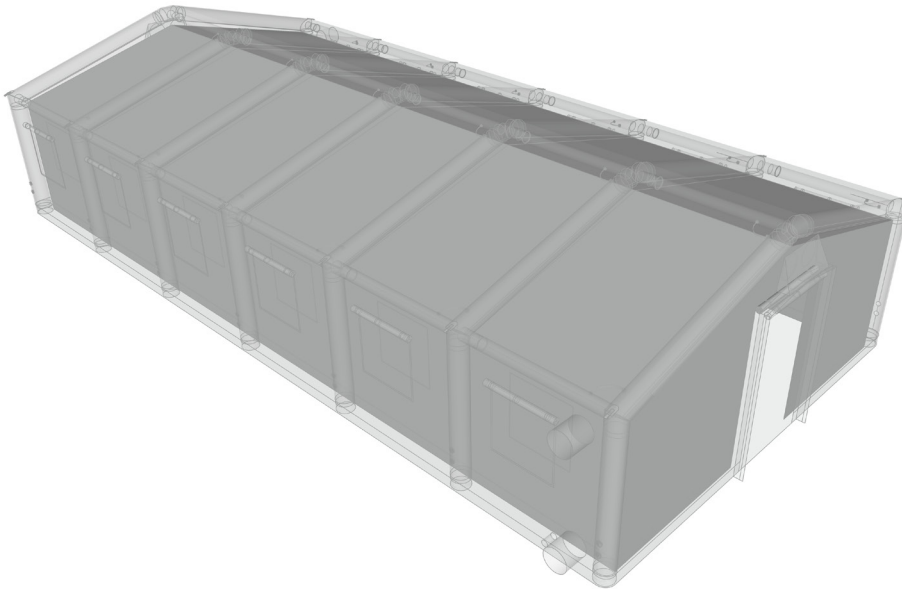

› Description

- › Insulation liner for improving the internal climate during cold and hot weather conditions
- › Improves the performance and power consumption of heaters or airconditioning when used

› Specifications

Dimensions	5.50 x 12.00 m (Floor area)
Side wall height	1.90 m
Center height	2.70 m
Door	Roll-up door with heavy-duty zipper and fold-down threshold - 120 x 210 cm
Windows	Clear PVC with insulation fabric roll-up flap on the inside - 80 x 80 cm, 6 per side wall, 12 in total
Standard features	Fixing points and hanging loops for lights and medical equipment
Standard accessories	Assembly and user manual
Materials	Quilted Polyester fabric with 80 g/m ² PES wadding in between, 320 g/m ² , breathable, FR CPAI 84
Operating temperature	-40°C / +50°C

› Graphic reference

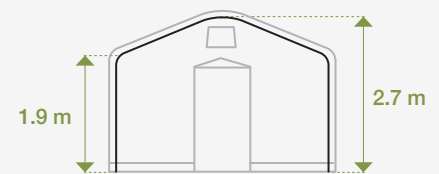

Floor area

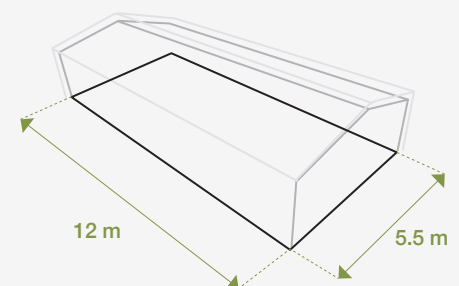

LegendAir-HPT | Insulation Liner 72 m²



Protection from cold and warm weather

› Packing and shipping

Dimensions 115 x 80 x 60 cm

Weight 150 kgs

*including transport-carry bag / user manual

Packing units (Three Insulation liners with accessories individually packed in PVC transport/carry bag on wooden pallet)

Dimensions 150 x 80 x 195 cm

Weight 475 kgs approx

Volume 1.794 m³

› Estimated loadability

Containers	Pallets	Units	Weight
20 FT	14	42	6,650 kgs approx.
40 FT	30	90	14,250 kgs approx.

Diesel Space Heater 30 kW



› Technical specifications

System	Diesel or kerosene powered hot air blower
Nominal heat output	Up to 30 kW
Application area	» Without insulation liner: up to 48 m ² approx. » With insulation liner: up to 72 m ² approx.
Max temperature increase	95C
Operating range	-20C to +45C
Max. fuel consumption	2.8 l/h
Tank capacity	50 liter
Power supply	220V / single phase / 50 Hz
Nominal consumption	230 W
Nominal current	1.5 A
Duct hose	300 mm Ø / 4 m length
Space heater	
Dimensions	120 x 80 x 55 cm
Weight	37 kg
Duct hose	
Dimensions	40 x 34 x 34 cm
Weight	8 kg

› Graphic reference

Space heater

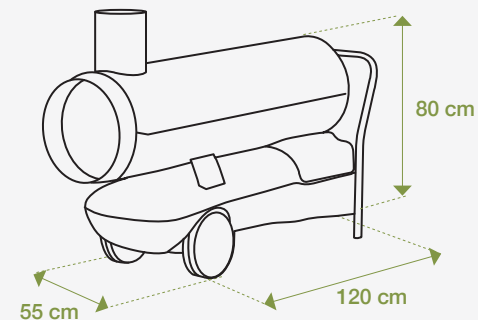

Diesel Space Heater 30 kW

› Packing and shipping

Space heater (Two units on pallet)

Dimensions	120 x 80 x 70 cm
Weight	99 kgs approx.
Volume	0.672 m ³

Duct hose (12 units on pallet)

Dimensions	105 x 95 x 70 cm
Weight	121 kgs approx.
Volume	0.513 m ³

› Estimated loadability

Containers	Pallets	Units	Weight
20'	27 + 5	54	3,280 kgs approx.
40'	60 + 10	120	7,150 kgs approx.

Mobile Air-Conditioning 4.6 kW



› Technical specifications

System	Split unit
Cooling capacity	1.80 kW to 4,6 kW
Application area	» Without insulation liner up to 36 m ² approx. » With insulation liner up to 72 m ² approx.
Setting range	+16C to +30C (Internal unit)
Operating range	+21C to +43C (External unit)
Refrigerant	R32
Power supply	220V / single phase / 50 Hz
Nominal consumption	1.37 kW
Nominal current	5.8 A
Starting current	8.0 A
Protection class	IP24 (Internal), IPX4 (External)

Internal Unit

Dimensions	75 x 50 x 35 cm
Weight	38 kgs

External Unit

Dimensions	55 x 55 x 25 cm
Weight	12 kgs

› Graphic reference

Internal unit



External unit

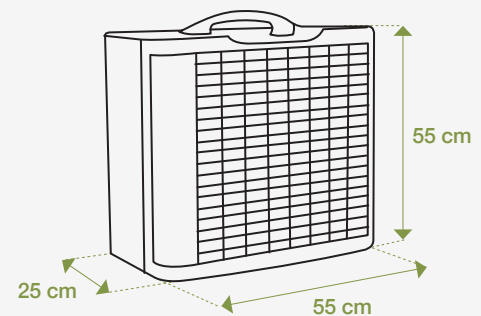

Mobile Air-Conditioning 4.6 kW

› Packing and shipping

Packing units (Two units on pallet)

Dimensions	115 x 90 x 80 cm
Weight	125 kgs approx.
Volume	0.828 m ³

› Estimated loadability

Containers	Pallets	Units	Weight
20'	28	56	3,500 kgs approx.
40'	60	120	7,500 kgs approx.